



On the Nail

A magazine for the
villages along the
Nailbourne



July
2022

DESIGN & PRINT | WEB DESIGN & HOSTING | VEHICLE WRAPPING & GRAPHICS | SIGNAGE

01227 780001 • micklecreative.com

Canterbury Roofing Specialist

- Slate roofs
- Kent pegs
- New roofs
- Repair work
- Fibreglass flat roofs
- All building work carried out

Family run business
www.rooferincanterbury.co.uk
 Contact Gary or Trevor for a free quote.

Syvilla
 Canterbury Road
 Chilham, Canterbury

Tel: 01227 731845 Mobile: 07796 165289

Mill Tower *Massage*

Offering holistic massages, I individually tailor each and every treatment to allow time for you to relax, whilst restoring your body's balance and sense of wellbeing.

For more information:
anita@milltowermassage.co.uk
 07813 272154



Bridge Haven Care Home

Conyngham Lane, Bridge, Canterbury CT4 5JX

At Bridge Haven 24-hour care and support is provided for people living with dementia, where our team of qualified and attentive staff focus on the individual needs of the residents.

Visit our website to see how we can help you:
www.avantecare.org.uk or call us on **01227 831607**

avanto
 care & support
'Everyone Matters'



Bourne

Veterinary Practice

Family owned and run
Convenient parking

Committed to quality care
Purpose designed modern practice

Relaxed atmosphere
24 hour emergency service

Consultations by appointment
Modern purpose designed facility

Rob and Rachel McMeeking

Chalkpit Farm, Adisham Road,
Bekesbourne, Nr. Canterbury Kent

CT4 5EU (Opposite Essentially
Hops)

e-mail : info@bournevets.co.uk

Web : www.bournevets.co.uk

01227 832322

Perhaps you need help finding the right artist for a family portrait, for advice on valuation, or to arrange a talk to a community group?

Art Services

Consultancy.

Art history lectures, classes and tuition.

Research and research assistance.

Writing services.

Sales.

Advice.

contact: tom@artacademy.org.uk



R.B.W

**KENT'S WATER FEATURE
SPECIALISTS AND
POND BUILDING EXPERTS**

Garden / Pond Design, Building and Refurbishments
Pond Cleaning / Maintenance / Maintenance Contracts

Child Safe Pond Covers

Filtration Specialists

Patios - Decking - Fencing - Brickwork - Arbours

Tel: 07563212858
FREE ESTIMATES and
CONSULTATIONS

www.ReflectionByWater.com
Email: andrewlongrbw@hotmail.com

We come to you...

Ginger Cat
COMPUTER SOLUTIONS

PC & Laptop Repairs. Data Recovery
Networking & Maintenance.

Repairs & New Systems . Upgrades.

Virus Removal/Protection.

info@gingercatcomputers.co.uk

www.gingercatcomputers.co.uk

01227 700730





Est 1988

Domestic Cleaning Services

Tel: 01227 277033

www.supermaids.co.uk

Email: info@supermaids.co.uk

Self-Catering Holiday Home Bridge (Centre)

Sleeps 7—(5 + 2 on sofabed), 3 Bedrooms
Available all year round.

Contact Tina:

07890 613 185 or 0118 375 0393

YOGA CLASSES AT LOWER HARDRES VILLAGE HALL

with Cheryl Rivers

Monday 10-11.30am

Tuesday 1.00-2.30pm

Wednesday 2.00-3.30pm

Thursday 10.00-11.30am

FIRST LESSON FREE

Please contact Cheryl Rivers on

01227 457707

www.yogawithcheryl.org

T. PETTMAN

CLOCKMAKER

0786 0498 963

FS Property Maintenance & Handyman

All aspect of interior & exterior,
residential & commercial property
maintenance undertaken.

All jobs big or small.

Friendly, reliable, reasonable

07980 364694

01227 722278



Computing & technology advice, support, tuition, repair

I provide all aspects of IT support to individuals
and businesses on a one-off or ongoing basis.

Ed Ludlow, Ed-IT Computing

t: 01227 472619 | m: 07494 404238

hello@ed-it.co.uk | www.ed-it.co.uk



ELITE BLINDS

MADE TO MEASURE

BLINDS AND SHUTTERS

tel: 01227 720881

website: elite-blinds.com

NACS Registered

Fully Insured

Chimney Lining

Pots & Cows

Fireplaces Fitted

CCTV Surveying

Rotary Power Sweeping

Stoves Installed & Serviced

01227 700 909 pjsweeps@hotmail.co.uk

WWW.PJCHIMNEYSWEEPS.CO.UK

P J Sweeps

Phillip Joiner

Chimney Engineer

Over 10 Years' Experience



HOPS & FLOWERS

BY ESSENTIALLY HOPS



Hop garlands for decoration | Dried Flowers | Gifts

www.essentiallyhops.co.uk

Chalkpit Farm Rural Shopping, Bokesbourne, Nr Canterbury, CT4 5EU

shop@essentiallyhops.co.uk | Tel: 01227 830 666



The Barn at Woolton Farm Relaunches 1st April

The Barn at Woolton Farm will re-open from April.

This summer there will be lots of exciting new developments including Live cooking in our new outside kitchen with Wood-Fired BBQ and stone Pizza Oven.

Kentish Pip Craft Ciders, Woolton Wines and Local Ales and more!

Check out our new bell tent Clamping experience.

We are looking forward to welcoming you all back soon.

Open Friday Evenings, All Day Saturday & Sunday, Monday – 2pm

Open everyday from July

Full Events Calendar on our website

www.wooltonfarm.co.uk Social Links: @kentishpip T:kentishpipcider

nicholas james

Cutting and styling hair **hair limited**

**in a relaxed and friendly environment with easy
free parking outside the door**

BED HEAD

TIGI

tel: 01227 830565

PAUL MITCHELL

4 western ave, bridge, canterbury, kent, ct4 5ls.

THE CITY SWEEP CHIMNEY SWEEP

Brush and Vacuum

All Chimneys, Boilers & Stoves Swept
Woodburning Stoves & Fireplaces Fitted
Chimneys Lined, Certificates Issued
HETAS & NACS registered, fully insured
Member of the National Association of
Chimney Sweeps

Tel: 01227 450888 Mob: 07813 716654

W.J.B. Plumbing Services

All aspects of plumbing carried
out by fully qualified tradesman.

Tel: 07783137448 or 01227
860480



Unit 11 Partridge Drive, Bridge
CANTERBURY CT4 5BF

(01227) 831928

Servicing & MOT's Classes 4,5 lights & 7
Welding

Full Diesel & Petrol Diagnostic
Cars collected and returned locally

Young's Accountancy Services

Accountancy, Bookkeeping,
Company Tax, Payroll, Personal
Tax & VAT Services.

Mob: 07561 112178.

Tel: 01303 259734

contactyoungstoday@gmail.com

Paw Patrols

DOG WALKING,
HOME BOARDING AND DAY CARE

Hannah Terry

Nearly 20 Years' Experience

Fully Insured and Licenced

Reference's Available on Request

07855 832045

BLACKWELL BUILDING SERVICES

BRICKWORK, PLASTERING,

CONCRETING, DRAINAGE

TILED & FLAT ROOFING, NEW
DRIVES, PAVING

PLUMBING, PAINTING, DOUBLE
GLAZING

Tel: 01227 860480



We specialise in bespoke, traditionally crafted oak
framed outbuildings, extensions & conservatories.

We also offer all general carpentry services.

Contact Mark or Helen for your FREE quote.

07977 304 968

honeyoakcarpentry@gmail.com

www.honeyoakcarpentry.co.uk

DMB PLASTERING

All aspects undertaken. Interior.

Exterior. Walls. Ceilings. Floors.

25+ years Experience

Construction Skills Certified

Also Coving / Drywall / Painting /

Repointing / General Repairs

Finest quality assured. Free Estimates

Reliable Service. Fully Insured.

Call or Text Dave on 07818
607209

Email: dmbplasteringuk@gmail.com

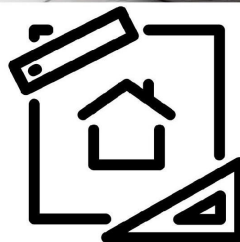

K.P Decorating

K.P Decorating Services

- Exterior decorating
- Interior decorating
- Floor and wall tiling
- Laminate Flooring
- General house maintenance

For a free quote and to discuss
exactly what you need give us a call
on: 07956455720 or visit our website
www.kpdecoratingservices.com



THE POOCHY POD

DOG GROOMING

07480 064280

105, Island Road, Upstreet,
Canterbury, CT3 4DE

thepoochypod@outlook.com

www.thepoochypod.co.uk



Canterbury Accordion Club

We invite accordionists to join us twice a
month at our sessions in Canterbury

Music Supplied

Any Standard of players welcome

Come along and see what we do.

For times and venue info please phone John on 01227721715 or
email kiwi.johnpnz@outlook.com

C W LYONS & SON LTD

FUNERAL DIRECTORS & MONUMENTAL MASONS

70 Military Road, Canterbury
24 Hour Service Tel: 01227 463508

Family Owned. Est 1911 Members of SAIF, NAFD & NAMM
 Prepaid Funeral Plans Available



Dean Fielder Plumbing Services

07595 266 270 / 01304 841224

dean@deanfielderplumbing.co.uk / www.deanfielderplumbing.co.uk

Friendly and Reliable - no job too small

All aspects of plumbing considered

- 💧 Bathrooms, taps, showers, pumps 💧 Radiators and valves
- 💧 Kitchens, sinks, taps, dishwasher and washing machine installation
- 💧 Water Softeners, instantaneous water heaters
- 💧 Hot and cold water supplies and storage, immersion heaters
- 💧 Ball valves, stop cocks, waste pipes, drips, leaks 💧 Outdoor taps
- 💧 Heating controls/valves 💧 Kitchen and bathroom tiling



Residential & Commercial Cleaning Services

DESIGNED WITH YOU & THE EARTH IN MIND.



07747 629819



Eco-Clean.Kent@outlook.com



www.Eco-Clean.org



ECO Clean Kent

CLARKS LANDSCAPE SERVICES

PRIVATE AND COMMERCIAL LANDSCAPING

Including garden design and construction. Grass cutting of fields, meadows and paddocks. Patios, paths, concreting, turfing. Hedging and site clearance. Grass cutting service from £4.00 per cut. "Logs for Sale"



The Orchard

Marley Lane

Kingston

CT4 6JH

Tel 01227 830536



Charles Bainbridge

National award winning
service and marketing
across sales, lettings and
property management.



01227 780227

charlesbainbridge.com

To advertise in this

magazine contact

stevelthomas91@gmail.com



The CANTERBURY
AUCTION Galleries



FREE ANTIQUE VALUATION SERVICE

Every **Friday 10am to 1pm**. Home visits by appointment.

CANTERBURY **01227 763337**

40 STATION ROAD WEST, CANTERBURY, KENT CT2 8AN

www.thecanterburyauctiongalleries.com



The Vicarage
23 High Street
Bridge
Tel: 01227 206272
E-mail: estellalast@gmail.com
July 2022

Dear Friends

What a wonderful Jubilee weekend? It was so good to be able to get together as whole communities to celebrate such an historic occasion! I really want to say a heartfelt thank you to everyone who put in time and energy to helping our communities to celebrate – concerts, street parties, jubilee picnics, fun days and flower arrangements don't happen by magic and so a sincere thank you to everyone who helped make this happen in our villages!

Last Sunday we launched something called 'The Parish Giving Scheme' in our Parish. As you know we have been working hard to streamline and modernise the way in which we manage and run the administrative and financial side of our churches and this work is ongoing. The Parish Giving Scheme, is a national not-for-profit scheme which has been set up as a way of enabling churches to receive donations via Direct Debit in the same way that other charitable organisations do, regulated and covered by the same Direct Debit Guarantee.

This means that anyone wishing to give to any of our 5 churches can simply set up a Direct Debit and we will receive 100% of your donation plus any gift aid (if you are eligible for us to claim it) at no cost to us (or you!) and with no involvement from our volunteers. At present this process is much more complicated and time consuming. The money received in this way is used to pay for the day to day running costs of our churches, including ministry costs, things like heating, lighting and general wear and tear. Our Friends organisations continue to fundraise for expenditure related directly to the buildings themselves and special projects and we continue to raise funds for other charitable causes through campaigns and events.

Money is tight just now I know and the cost of living is going up which means there is less spare money around but the costs of running and maintain churches go up too, the same as for everyone else.

If you already give regularly to the church in some way (or even if you don't), if you would like to see us to continue to be able to offer the service that we do in all of our villages and more importantly if you would like to see our work grow (!) please do consider signing up and giving a regular monthly amount. Even if you can only afford a little, as the saying goes 'Every little helps'!

Those of us who have faith believe that we serve a generous God who has given us extravagant blessing in Christ and in life in general. As we respond to God, both by the giving of time and money, our prayer is that God might grow our church in a way that would honour God and continue to serve our communities faithfully as we have for so many hundreds of years.

Lastly, if you are experiencing hardship of any kind please get in touch as there are many ways in which we can help.

Yours in Christ,

Estella Last

Rev. Estella Last, Vicar, The Bridge Group Parish

Diary Dates for July

Fri 1st - 8.45am Parent's Prayer Group, Bridge Church

Sat 2nd – Bridge Village Fete, 12-4pm Bridge School Field

Mon 4- 1pm-3pm BREW, Bekesbourne Recreation Ground

Thurs 7th 9-11am Little Lambs Toddler Group, Bridge Pavilion

Fri 8th – 8.45am Parent's Prayer Group, Bridge Church

Sat 9th – 4pm-6pm Messy Church at Bridge and Patricxbourne School

Mon 11th - 1pm-3pm BREW, Bekesbourne Recreation Ground

2.30pm Caring and Sharing

Wed 13th – 10 am village coffee morning, Bekesbourne Recreation Ground

Thurs 14th 9-11am Little Lambs Toddler Group, Bridge Pavilion

10.15-11.30 Fish Scheme Coffee Morning Bridge Village Hall

Fri 15th –8.45am Parent's Prayer Group, Bridge Church

Mon 18th - 1pm-3pm BREW Bekesbourne Recreation Ground

Thurs 21st – 9-11am Little Lambs Toddler Group, Bridge Pavilion

Fri 22nd – 8.45am Parent's Prayer Group, Bridge Church

Mon 25th - 1pm-3pm BREW Bekesbourne Recreation Ground

2.30pm Caring and Sharing

**Please note that this year we are planning
on producing separate August and
September Magazines**

Service details and readings for July and August 2022

Date	Known as	Readings	Church Service
3 rd July	3 rd Sunday after Trinity	Isaiah 66.10-14; Psalm 66.1-9; Galatians 6.(1- 6),7-16; Luke 10.1-11,16-20	8am BCP Communion St Mary's, Nackington 10am Songs of Praise St Pe- ter's Bokesbourne 6pm Choral Evensong St Mary's Lower Hardres
Saturday 9 th July			4-6pm Messy Church at Bridge School
10 th July	4 th Sunday after Trinity	Deuteronomy 30.9-14; Colossians 1.1-14; Luke 10.25-37	10 am Communion at St Pe- ter's Bridge (Rev'd Miriam Presiding for the first time!)
17 th July	5 th Sunday after Trinity	Genesis 18.1-10a; Psalm 15; Colossians 1.15-28; Luke 10.38-42	9.30am Morning Prayer at St Mary's Nackington 10am Traditional Sung Holy Communion at St Mary's Patricxbourne 4pm All Age Family Service at St Peter's Bridge
24 th July	6 th Sunday after Trinity	Genesis 18.20-32; Co- lossians 2.6-15,(16-19); Luke 11.1-13	10am Parish Communion St Peter's Bridge
<u>31st</u> July	7 th Sunday after Trinity	Ecclesiastes 1.2,12-14; 2.18-23; Colossians 3.1- 11 Luke 12.13-21	10am Benefice Communion at St Mary's Nackington
7 th August	8 th Sunday after Trinity	Genesis 15.1-6; Hebrews 11.1-3,8-16; Luke 12.32- 40	10am Songs of Praise Service with Communion at St Peter's Bokesbourne
14 th August	9 th Sunday after Trini- ty / Blessed Virgin Mary	Isaiah 61:10-end Galatians 4: 4-7 Luke 1: 46-55	10am Benefice Communion at St Mary's Lower Hardres - Patronal Festival
21 st August	10 th Sun- day after Trinity	Isaiah 58.9b-14; He- brews 12.18-29; Luke 13.10-17	10am Benefice Communion at St Marys Patricxbourne
28 th August	11 th Sun- day after Trinity	Proverbs 25.6-7; He- brews 13.1-8,15- 16; Luke 14.1,7-14	10am Benefice Communion at St Peter's Bridge



In your garden with Marie Gold



***“Now summer is in flower and nature’s hum is never
silent rounder her sultry bloom”***

John Clare

This month it must be for bees and the flowers they love and need. We need bees and they need our flowers. There are 200 varieties of bees, and some are dying out, but it is usually up to 20 varieties that can be found in the garden. If you have the space plant lavender, asters, zinnias, cosmos, erigeron karvanskus and open flowered hardy geraniums, but particularly flowers with open petals, not the fancy crinkled ones that bees cannot access. A dish of clean water will be welcome as they need to drink. I like to watch them disappear up a Foxglove flower. My best bee plant is Teucrium Lucidrys and if you can find one, you will not regret having it in a sunny spot.

When you are at home and in the garden take note of which bees are visiting your own space, which flowers they like and see how many varieties you and your family spot. This will go a long way to ensuring their survival on this planet is for years to come. The family will enjoy making a Bee & Bee (formerly known as a Bee Hotel). A small wooden box and cut down canes and hollow stems, are all you need. I soon found that pinecones are not suitable as they easily close when wet.

For a family garden visit: 16th and 17th July 1.30-5.30 – home-made teas - Stable House, Heppington, Street End CT4 7AN specifically for its 5-acre wildflower meadow with mown paths so you can meander through it and get up close to all the insects and butterflies – I went last year on a sunny day, and it was magical. Adm £4, children free and they will love it.

Happy start of summer



'Pet Service'

Songs of Praise

Sunday 3rd July

10am St Peter's Bokesbourne

**A service of music and song to celebrate the pets in our
community.**

All welcome.

Royal British Legion

We had a good meeting on Tuesday 14th June when 12 members attended. We are looking forward to a return match in the autumn when we go to Staple for another Quiz Night. As usual, we are seeking new branch members (ex-service or not, it doesn't matter, everyone is welcome to join us). Just contact the Vice Chairman on 01227 472023 or find information in our notice board outside the Village Hall. Our next Branch meeting will be on Tuesday 12 July at 8pm in the Recreation Club.



CHRISTIAN AID WEEK 2022

Many thanks to everyone who put envelopes in letter boxes, supported the two Soup Lunches or donated in any way during Christian Aid Week. The total raised was £1,270.29.

This is noticeably down on previous years' collections, but considering the demand on everybody's finances this year, still a valuable contribution to helping people across the world who are suffering from the effects of drought caused by climate change. It will be greatly appreciated.

The children at Bridge and Patricxbourne Primary School also raised £272.03 through the 300,000 Steps Challenge which every child in the school took part in. Many thanks to them and the school staff also.

If you missed this year's collection and would still like to give, you may do so online at the Canterbury Christian Aid Group's Just Giving page www.justgiving.com/fundraising/camoo0407

Supporting your local Church through regular giving



**We are launching the Parish Giving Scheme
as a simpler and easier way for you to give
to your church in The Bridge Group Parish.**

To set up your gift call the PGS team on
0333 002 1271, scan the QR code.
or visit **www.parishgiving.co.uk**



Your Parish Code is 06A606008



For help and support contact
Evelyn Andrews 01227 830960

**If you would prefer to use a paper form to set up your
Direct Debit please contact Evelyn on the number above
and she can let you have a form.**

Thank you



Bridge & Patrixbourne
Church of England Primary School

2022

Bridge Village Fete

GATES
OPEN
12 Noon

12 to 4pm

Saturday 2nd July

Games, Inflatables, Music, BBQ,
Refreshments and much more.

Kindly supported by



Charles
Bainbridge

Multi award-winning property experts

Bridge with Patrixbourne Womens Institute

The Jubilee Tea Party, held in the Pavilion on the Recreation Ground, was a huge success – well supported by people from the village and around. The wonderful variety of delicious cakes, baked by members of the committee, were enjoyed by all and the raffle, book stall and plant stall were all popular. We were fortunate to have a warm, sunny day, when tables were filled – both indoors and outside and everyone enjoyed the happy and relaxed atmosphere.

Our next meeting will be on **Tuesday, 19th July** at 7.30pm in the Village Hall, when Mr H Smith will be giving a talk on **1950's Britain**. Anyone wishing to come as a guest, is welcome.

On **Friday, 19th August**, tea has been booked at the **Elham Valley Vineyard**, where the Restaurant is excellent, and there is an extensive Garden Centre, with many tempting plants and shrubs.

Joan Hill

June 2022



Saturday 9th July

4-6pm

Bridge and Patrixbourne School Hall

Crafts, worship, stories and a hot dinner!

All welcome.

Bridge FiSH Scheme

We had a lovely Jubilee meeting in June with bunting, flags, vintage crockery and delicious cakes. We also welcomed Emma Haynes from Bridge School who came along with some children to talk about the Silver Stories scheme. This is an inter-generational scheme to promote good relationships between young children and older people through reading stories. Bridge School would pair an older person with a younger person and they would chat once a week and share a story together. If you might be interested in this scheme contact the Fish Scheme or Emma at emma.haynes@bridge.kent.sch.uk. And the website for further information is www.silverstories.co.uk.

Our next coffee morning is on the 14th July, we look forward to seeing you there at 10 ish. If you, or someone you know, needs transport to the Coffee morning then please call us on 07935 966080.

Friendship
Independence
Support
Help

The Village Gardeners

The large and blousy Alliums have bloomed at Green Court but the smaller (sphaerocephalon) Alliums are just about the burst forth. Come along and take a look. They should look amazing.

If you live around Green Court or Western Avenue, or are just passing by with a handy pair of gardening gloves, can you help us by pulling any thistles that you see? We are battling with the thistles in the large sunny bed and don't want them to spread into the bark area that we are gradually rewilding. If you place them by the compost bins (which are padlocked for safety reasons) we will pop them in when they are dry and there's no chance of transferring the seed. We would welcome any help with that area, but would particularly welcome help from anyone surrounding Green Court who might be able to lend a hand sometimes. Please get in touch. We have a further request re. our new area at the corner of Conyngham Lane and the High Street. The area is coming along well, although slightly suffering from the prolonged dry periods we have had this year. We are looking for a volunteer who could mow around the border during the growing season to keep the area looking tidy. Could you help with this? KCC are doing a grand job with this currently, but only have use of a strimmer which sometimes covers the area with grass clippings and makes it look untidy. If you live around that end of the High Street or Conyngham Lane and have a little time to spare, (and a petrol mower!) please get in touch.

If you can help in any way contact Sue (sr. arw52@gmail.com) or Pam (pamelafdobson@gmail.com).

The Village Gardeners..... helping the village to bloom.

Woodpeckers Nursery

There are some more exciting changes coming to Woodpeckers as a new committee was formed on June 13th. The new committee will include members of staff at Bridge and Patribourne School and parents from the setting allowing stronger links to be built with the school and the sharing of knowledge and expertise. Unfortunately, after 4 years as the setting manager, Michelle Briggs will be moving on as her family are relocating to Lancashire. We wish Mrs Briggs the best of luck and thank her for everything she has done for the nursery. Our current deputy, Jo Richards, will be acting as Manager whilst the committee find the perfect person to drive the nursery forward.

Our next fundraising event will be at the Bridge Village Fete please come along to support the fantastic work of the nursery and to meet the new team. You can also help support the nursery by donating via one of our online giving schemes.

<https://givealittle.co/campaigns/17030a08-9409-4cfa-82e0-e9f53db04ab8>

https://www.easypfundraising.org.uk/causes/woodpeckersnursery1/?utm_campaign=raise-more&utm_content=cpl

As we come to the end of another busy year the staff and committee at Woodpeckers Nursery would like to wish all of the children moving on to school this year the very best and look forward to welcoming our new families in September.

Woodpeckers Committee

Nailbourne Horticultural Society

A reminder of the Society's Summer Show in Bridge Village Hall on Saturday 23 July. The Show will be open from 11.30 am to 2.00 pm, with prize giving at 1.45 pm and light refreshments served throughout the day. There will be a plant/bring and buy stall and, of course, a raffle. The various classes in the Show include vegetables, fruit, cut flowers, pot plants, cookery, floral arrangements, handicraft and photography – indeed, something to interest everyone. There are also 7 open classes for everyone to enter, not just members, and details of these are available from Kathy Walder, Show Secretary, 830057 / 07791 [656539](tel:656539) / kath@askwalder.com Please remember that entries for the two open photographic classes entitled "Transport" and "Tranquillity" are to be emailed to Kathy no later than Saturday 9 July. A reminder, too, to members to bring along on the day their Chairman's Challenge Chilli Pepper that they are carefully nurturing!

We do hope that you will come and visit us in the hall on Saturday 23rd to enjoy a splendid display of entries and to support all the exhibitors and the Society in general.



The Bridge Group Parish Baby and Toddler Group

Thursdays during term time

9am-11am

in Bridge Sports Pavilion, Bridge Recreation Ground.

Suggested donation £1.50

For more information email estellalast@gmail.com



Nailbourne Horticultural Society



Summer Show



Saturday 23 July, Bridge Village Hall

Show open to public 11.30 am to 2.00 pm

Presentation of Prizes 1.45 pm

Includes 7 Open Classes (for all to enter):

Please contact Kathy (details below) for more information



Refreshments

Plant/Bring and Buy Stall

Raffle

For Show Schedule and more details, contact Kathy on 830057/07791 656539/kath@askwalder.com



THE QUIET VIEW

As well as being a Centre for Contemplative Spirituality, the Quiet View is a Community Retreat Garden, and so we would like to invite you all to come sometime to meet Angel. She is over 20' tall and has been exquisitely carved from a dying ash tree by local Wood Sculptor, Daniel Hilton. (www.iswoodgood.co.uk) Here's the link to a beautiful 5 minute video of the Angel's creation process -

<https://youtu.be/wRoqYNIPFG0>

We have been open every day since Lockdown, without the need to book, so people can wander in the garden, yurt and the labyrinth to find peace, rest, comfort, inspiration – and now we invite you to come to experience the power of this stunning angel sculpture. Our intention is that she will give us a sense of the angelic realm for angels are always longing and waiting to guide our souls from darkness to light.

Sunday 10th July is an **Open Day** when we shall be serving refreshments from **11am – 4.30pm** – so do pop in, meet Angel and share a drink and a snack with us! Donations are always welcome to the Angel Fund!

We have been amazed but not surprised at the numbers of people who have been visiting and leading new groups since the start of the pandemic. Many are discovering a new spiritual thirst and in an inclusive way we welcome all. Some of our regular events include **Taizé Prayers, Taoji Qigong, Yoga, Spirit Dance, Healing Drum Circle, Sound Baths, Silent Retreats, Kirtan, Sacred Earth Chants** and some other special events coming up include –

SILENT RETREAT, 'Finding Hope in Silence' Friday 15th July
10.30am – 4pm led by Lizzie £25 Please book with Dr Julia Ronder – newron.julia@gmail.com

CREATION, CREATURE, CREATIVITY - Saturday 10th September
10.30am – 4.30 pm – an adventure in poetry and spirituality from c1400 BCE to 1961 with **Peter Brennan** of Visionary Company Courses **£50**

MANDALA – A TRANSFORMATIVE DAY with Sue and Debbie - Saturday 17th September 10.30- 3.30 £25 - an opportunity to connect with ourselves in the healing power of the Spirit .

Do get in touch for more information or to be on our mailing list – [liz-
ziehopthrow@gmail.com](mailto:lizziehopthrow@gmail.com) There's the website too www.quietview.co.uk

We hope to welcome you soon

Lizzie and John
The Quiet View
146 The Street Kingston
CT4 6FG
01227 830070



Kate's Puddings – What's Cooking?

This was the first recipe I put onto my puddings blog, back in January 2013. It is still one of my top five favourite puddings, and one I will be making for the Stour Music Festival, where I have the joy of making all the puddings in the Artists' tent. I have just bought the first 12 pints of cream to get me started! For Stour I make a double quantity, as pictured – any larger and you have to use a clean washing up bowl for the mixing. The original is from the much-used Penguin Hume and Downs Cordon Bleu Cookbook.

Cold Lemon Soufflé

3 large eggs
8oz/225g caster sugar
2 ½ lemons
½ pint/300ml cream
½ oz/12g gelatine (leaf or powder)
½ gill water (2.5 fl oz/75ml)
To finish: extra cream

Separate the eggs and place the yolks, sugar and grated lemon rind in a bowl and whisk until thick. I usually do this in a Kenwood with the whisk. Heat the lemon juice, add, and continue whisking "to the ribbon" (ie, pale and very thick). This takes ages, and my Kenwood died at this point in 2017.

Half-whip the cream and fold into the mixture. Dissolve the gelatine in the water over heat and stir into the mixture. Whisk the egg white until stiff peaks but not dry. Set the soufflé mixture on ice and fold in the egg whites (I don't bother with the ice). This is easier if you stir in a tablespoon of whisked egg white first to break the mix up a bit and then fold in the rest. (It's very hard to avoid little islands of egg white.)

As the mixture begins to thicken, turn at once into a large bowl and put in the fridge to set. When firm, decorate with cream and anything else that takes your fancy.

There are more delicious recipes on <https://katespuddings.blogspot.co.uk>

BRIDGE HEALTH CENTRE

Permanent Clinical Hair Removal
Many other skin blemishes treatable

01304 380249

Jacqueline Tall MBIAE CRPE (Fellow) DAE

B&C Roofing

All your roofing needs
No job too small
Fully insured.

Local, friendly, reliable service

FREE QUOTATIONS

Call Ben 01227 363366

07949973176

Plastering

(City & Guilds)

- . Interior Plastering
- . Coving fitted
- . Exterior Rendering
- . Painting- Interior & Exterior

Chris Possee

3 Green Court

Bridge, Canterbury,

Kent CT4 5LU

07805 695247

Canterbury and Bridge Upholstery

We have a wide range of fabrics to
choose from in your own home

Call us for a free quote on

01227830855 or 07757029558

Local recommendations available

Debden Decoration & Design

Painting, decorating and interior design

Fiona Castle

07971 970118

debden-decoration-and-design@gmail.com



debden-decoration-and-design

We clean your oven...

*...so you don't
have to!*

**Oven
Wizards™**
We clean your oven...so you don't have to

Call David Bayliss on:

01303 488237

www.ovenwizards.com



NEED A VAN? THEN I'M YOUR MAN

For all light removals, furniture, and domestic
items including house clearances.

Safely transporting antique furniture a speciality.

* Avoid expensive pick-ups and drop-offs

* Remove, dispose or recycle all household items
including electrical appliances

* Based in Barham

* Reasonable and fair rates

* Free estimates and quotations

CALL CHRISTIAN ON:

01227 831639

07771 728080

Email: christianmanandvan@gmail.com

MOLE CATCHER KEITH

No Mole – No Fee

Your local Mole catcher, based in Ash, covering
all local towns and villages.

Offering mole control for your lawns, gardens &
paddocks. Public liability insurance.

Call/Text

East Kent Mole Catcher 07876 686543

Email—molecatcherkeith@hotmail.com



BEKESBOURNE STABLES

Liveries, hacking and lessons for all
ages and abilities
Pony rides and parties
Horses taken for schooling
Horses hired out for hunting
We are a fully licensed and insured
establishment
with many year of experience.

Situated in walking distance from
Bekesbourne Station, CT4 5EX

For info or to book call
01227 830910 or 07764776057

Allport Cars
Airport & Seaport Transfers

First class, long distance travel service

Local family business
Pleasure & business travel
Up to eight passengers

For a free quote or more information contact:
01227 370370 office@allportcars.co.uk
allportcars.co.uk



SARAH de ROUGEMONT
UPHOLSTERY
Established 1990



Loose Covers - Fabrics - Roman Blinds
All commissions considered
Tel: 01227 455841
Mob: 07973 377817

Woolton Farm Accommodation



**We run three delightful Kentish self-
catering holiday houses, two are on the
old village green in Littlebourne and
the other one is on our fruit farm in
Bekesbourne**

**For more information please visit
our website at
wooltonfarm.co.uk/accommodation
Tel: 07730910890**

TEL:01304 813372

THE CARPETMAN

MOB:07976 037683

David Brazier est, over 25 years

Local supplier and fitter of

CHOOSE FROM A HUGE RANGE OF CARPETS,
VINYL AND OTHER FLOORING AT BELOW SHOP
PRICES IN THE COMFORT OF YOUR OWN HOME

THE SCHOOL HOUSE
WARE
ASH



**ASHTON
TREE CARE**

07929 627622
ashtontreecare@gmail.com

City & Guilds
NPTC

ALL WORK
FULLY INSURED

- HEDGE CUTTING
- STUMP GRINDING
- TREE SURGERY



Canterbury Guided Tours run twice daily (11am & 2pm) 90-minute official guided city walking tours starting at the Buttermarket.

Led by expert Green Badge Guides, our route includes the Cathedral Precincts and cloisters.

Private and bespoke group tours also available at dates and times to suit.

10% discount available for our daily tours only to local residents and friends using the code NAIL3522 visit www.canterburytouristguides.co.uk or

email guides@canterburytouristguides.co.uk to book and claim the offer.

Canterbury Guided Tours reserve the right to remove the offer at any time.

**CANTERBURY
GUIDED
TOURS**

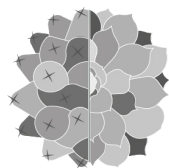

BRITISH CACTUS AND SUCCULENT SOCIETY HERNE BAY & DISTRICT BRANCH

MEETINGS ARE HELD
EVERY THIRD WEDNESDAY OF THE MONTH FROM 7.30PM
at

THE OVER 60's CLUB, PETTMAN HOUSE,
HANOVER SQUARE, HERNE BAY. CT6 5NY

- ◆ Entertaining speakers
- ◆ Variety of topics
- ◆ Free refreshments
- ◆ Friendly chat

NEW MEMBERS ARE ALWAYS WELCOME
For further details please contact
Philip Andrews Tel: 01227 830960

AcklandWebb

Chartered Certified Accountants and business advisers

- Local family business
- Friendly & professional service
- Specialists in small to medium-sized businesses & start ups
- Full range of accountancy and tax services
- Testimonials & references available
- No cost/no obligation initial meeting

Contact: David Muggridge

Tel: 01227 811745

Email: enquiries@acklandwebb.co.uk

Web: www.acklandwebb.co.uk



LANDCARE



**Tree Surgeons
Fencing
Landscapes
Maintenance**

NPTC certificated
Fully insured
20 years established
Local references available

www.landcaretreesandfencing.co.uk
07740-949836 07770-899548

Majestic Garden Care



**01227 694123
07930 025683**

Professional garden care specialists with expertise in large gardens and private estates. Our experienced and dedicated team offer an exceptional service in caring for all aspects of your garden.

www.majesticgardencare.co.uk

majesticgardencare@gmail.com

BARKING BEAUTIES KENT

Unit 11, Barham Business Park, Park Valley Road, Barham, Canterbury Kent CT4 6DQ

Telephone: 01303 840456



Fully Qualified City & Guilds grooming in the following technique

- Bathing, drying and nail clipping
- Full breed standard clip to breed styles
- De-matting
- Hand stripping and de-shedding
- Fully qualified City and Guilds Master Diploma and K9 First Aid qualified
- Fully insured salon
- Equipped for larger breeds as well as toy and small
- Established groomers



City &
Guilds

PIF
PIT INDUSTRY FEDERATION



Prices start from £15 for simple wash & blow dry. Find us on Facebook under Affinity Barking Beauties

To advertise in this magazine email

stevethomas91@gmail.com

GreenStone
CHARTERED
SURVEYORS

If you are looking to buy a residential property in East Kent, we are independent Chartered Surveyors that specialise in:

- RICS Building Surveys
- RICS Homebuyer Report
- Valuations

We provide a professional, friendly and approachable service with over twenty years experience.

07443 496025



greenstone.surveyors@hotmail.co.uk

Ty Bryn, Patricxbourne, CT4 5BT

www.greenstonesurveyors.co.uk

To advertise in this magazine email

stevethomas91@gmail.com

Living your life in the home that you love ...

Are you finding things a bit more of a struggle but don't want to give up your independence?

Live in care is a realistic, affordable alternative to residential care which lets you stay in control and continue to enjoy all your usual home comforts and social activities. Our care workers are fully trained and highly committed to meeting your needs in the way that you choose.



Canterbury & Thanet

To find out more why not contact our friendly and professional management team?

Tel: 01843 570638 or 01227 206473 Email: canterbury@bluebirdcare.co.uk

T 01227 832610 M 07534 288864

E info@bournetogarden.com

Bourne
to
Garden

Gardening services including:

- | | | | |
|---------------------|------------------|---------------------|----------------|
| ■ Fencing | ■ Landscaping | ■ Regular contracts | ■ Turfing |
| ■ Garden clearances | ■ Lawn treatment | ■ Seasoned logs | ■ Weed control |
| ■ Hedge cutting | ■ Mowing | ■ Tree surgery | |

Fully qualified and insured

www.bournetogarden.com



Environment
Agency



for the largest choice call

BERRYS

CANTERBURY LTD

the Premier Letting Agents



01227 765268

70 Castle Street Canterbury

www.berryscanterbury.co.uk



Hart Lee

Tree Surgery & Stump Removal
Domestic & Commercial Contractors

- All Aspects of Tree Work
- Garden & Site Clearance
- Hedge Trimming
- Fully Insured



Call Tony

T:01227 506990

M:07708 537683

W:hartleetreesurgery.co.uk



BASE PLASTERING

www.baseplastering.co.uk

For All Your Plastering Needs

- | | |
|-------------------|-----------------------|
| ■ Plastering | ■ Ceiling Replacement |
| ■ Skimming | ■ Plaster Over Artex |
| ■ Rendering | ■ Water Damaged |
| ■ Plasterboarding | ■ Patching & Repairs |
| ■ Ceiling Repair | ■ Coving & Cornice |

T: 0793 201 2847

E: info@baseplastering.co.uk

*No job too small
Friendly, Clean & Reliable
Competitive rates
Please call for **FREE** estimates*

www.baseplastering.co.uk

Cw roofing specialist

- roof replacement
- roof repairs
- fiberglass and felt
- flat roofs
- chimney repointing
- and repairs
- fascia soffit and
- guttering
- lead work
- All roof cement work

please do not hesitate to call for
a friendly free quote or advice
07943575082

DELTA ELECTRICAL SERVICES

DOMESTIC & COMMERCIAL
ELECTRICAL CONTRACTORS

SHAUNE MILBURN

MOB: 07702 333898

EMAIL: deltaelectricalservices@hotmail.co.uk

REGISTERED NICEIC
DOMESTIC INSTALLER



People of the Bridge Group of Churches

The Vicar:	Rev. Estella Last	01227-206272 estellalast@gmail.com
Curate:	Rev. Miriam Hinksman	07423-735398 bridgecurate@gmail.com
Reader:	Mrs Margaret Clarke	01227-765598 mrsmaclarke@yahoo.co.uk
Chaplain:	Mrs Miriam Westendarp	01227 206272
Administrator:	Mrs Megan Shirley	bridgeoffice23@gmail.com
Safeguarding Officer:	Rosemary Whatley	01227-206272

St Mary's Patricxbourne with St Peter's Bridge

Churchwardens:	Dr Andrea Nicholson	01227-830947
	Mrs Pauline Pritchard	01227-830685
	Mr Laurence Dunderdale	01227-830668
	laurence.dunderdale@gmail.com	
(Gift Aid Officer)	Mrs Evelyn Andrews	01227-830960
	evepurlins@btinternet.com	
PCC Secretary:	Mr Rory Wetherell	01227-830318
PCC Treasurer:	bridge.gp.treasurer@gmail.com	
Christian Aid/Organist	Mrs Jean Barber	01227-831956

St Peter's Bekesbourne

Churchwarden	Mrs Nicky Fry	01227-830319
	nicolafry@cscope.co.uk	
PCC Finance Team:	Mrs Zan Clifford	01227-830328
Tower Captain:	Mrs Gill Moon	01227-832134

To advertise in this magazine, please contact stevethomas91@gmail.com
01227-832573

To offer items for publication in this magazine, including event information, please contact Mrs Megan Shirley bridgeoffice23@gmail.com by the 15th day of the preceding month, ensuring that any emails and attachments are clearly titled to identify their content. Files should be submitted in .doc .pub or .jpg format. Posters should be A5 in size and both portrait and landscape versions provided.

Benefice Website: www.bridgechurchgroup.co.uk

Facebook: www.facebook.com/bridgcanterbury

Youtube: www.youtube.com/channel/UcKTHbcWKzslHJAuYcuMoOdQ

Cover photos: Mrs Megan Shirley and Dr Daniel Edward Young